



High Performance
Cassette-Size Wireless
a-Si Flat Panel Detector
M1417F

- | Full AED control |
- | 150 μm pixel pitch, with 16 bit ADC for more image details |
- | Longer battery life and smart workflow |
- | IPX4 high degrees protection |
- | Faster workflow for better user experience |

IMAGING THE FUTURE

M1417F is a new generation of high-performance 14×17 inch wireless static FPD, with more reliable AED function, more image details, and better battery endurance. Cutting-edge technologies, such as charge in tray, high-protection design, and lightweight structure, provide excellent solutions for high-end DR system.

High Performance Cassette-Size Wireless a-Si Flat Panel Detector

Technical Specifications

M1417F

Detector Technology	Amorphous Silicon
Scintillator	CsI
Active Area (mm²)	350 × 425
Pixel Matrix	2336 × 2836
Pixel Pitch (μm)	150
Spatial Resolution (lp/mm)	3.3
AD Conversion (bit)	16
Battery Autonomy (h)	3.5
WIFI	2.4G and 5G , IEEE802.11 a/b/g/n/ac
Trigger Mode	AED / Software
Full Image Time (s)	Typ.7
Dimension (mm)	460 × 460 × 15
Weight (kg)	3
Static Loading	150kg Uniformly
Ingress Protection	IPX4
Operating Temperature (°C)	5~30
Storage & Transport Temperature with Package (°C)	-20~50
Operating Humidity (% RH)	10~80 (Non-Condensing)
Storage & Transport Humidity with Package (% RH)	10~90 (Non-Condensing)

Dimensions

Unit: mm

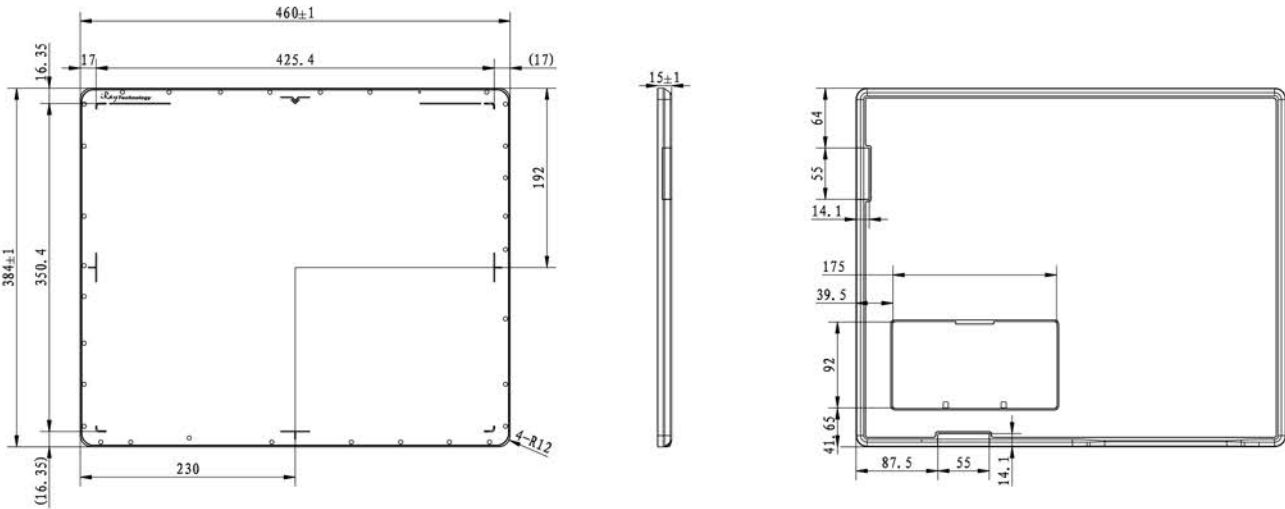

CHINA

WEIFANG NEWHEEK ELECTRONIC TECHNOLOGY CO., LTD

Tel: (+86 0536) 8882360
Fax: (+86 0536) 8882360
Email: newheek.newheek.com

The North 2nd Floor of No.1 Factory Building of No. 13426 Yuqing
East Street,Hi-Tech Industry Development Zone,
Weifang, Shandong, China P.C 261061